

# Lancaster Farmhouse



- 3 bedrooms, expandable to 5 bedrooms.
- 2 and a half bathrooms, expandable to 3.5.
- Two car integral garage.
- Second floor laundry room
- 2-storey wood & brick front porch.
- Walk-out bay window in kitchen.
- Simulated Divided Lite wood windows.
- American bond brickwork.
- Authentic period styling.
- Brick patio.
- Wide oak flooring entire first floor.



**JERRY HORN CONSTRUCTION**

COMMERCIAL • INDUSTRIAL • RESIDENTIAL

Call Don Horn at (724) 443-2090 or [donhorn@consolidated.net](mailto:donhorn@consolidated.net)



**DON HORN**  
Housewright

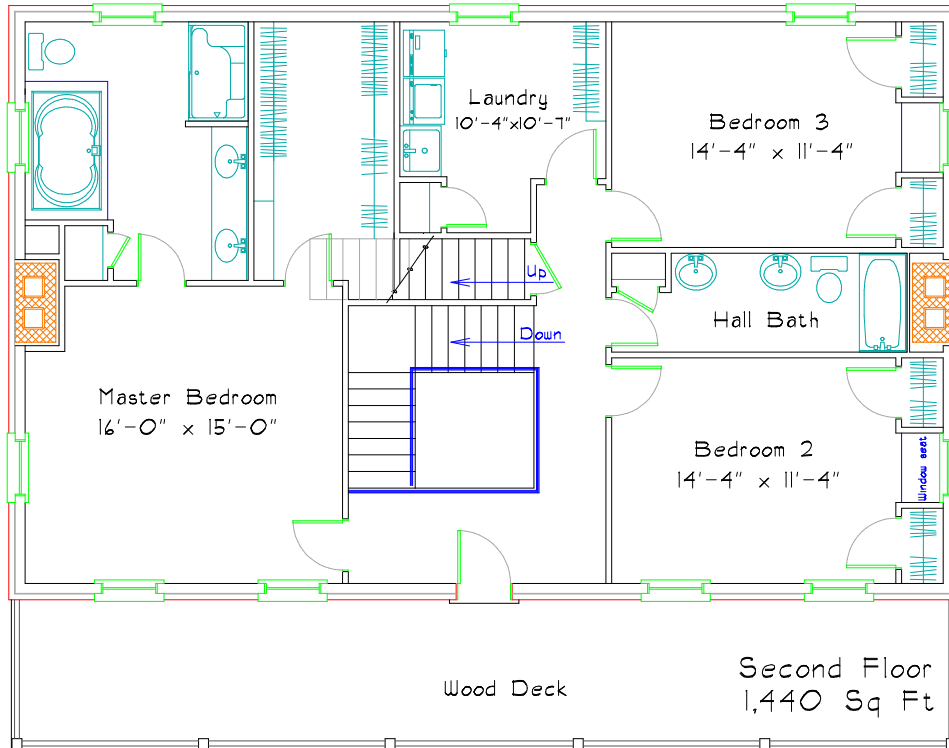

## Lancaster Farmhouse

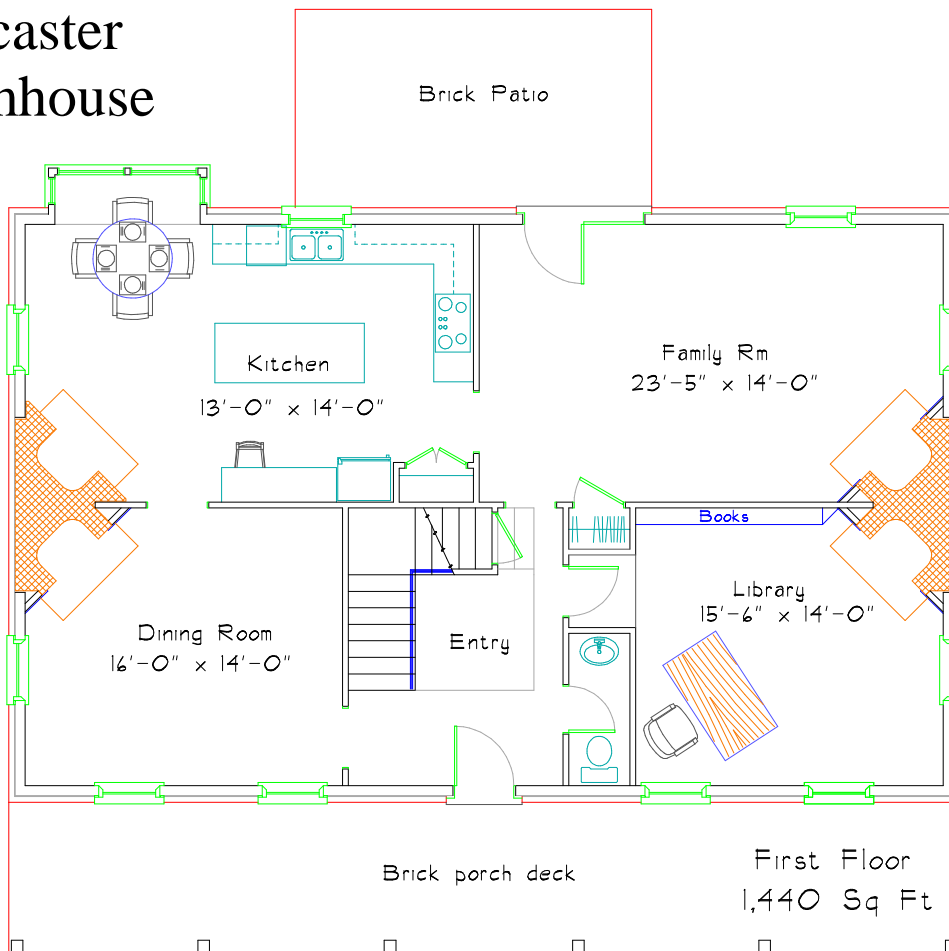

This plan has 2,880 square feet of finished living space and was designed by Don Horn as a custom home. The basement includes an integral 2-car garage. This plan can be modified to suit your needs.